

- 8 sizes with load capacities ranging from 6,000 lbs to 88,000 lbs (2,750 kg to 40,000 kg) per wheel
- Wheels of various shapes and designs – made of spheroidal-graphite cast iron (GGG 70), polyamide or featuring Hydropur tyres

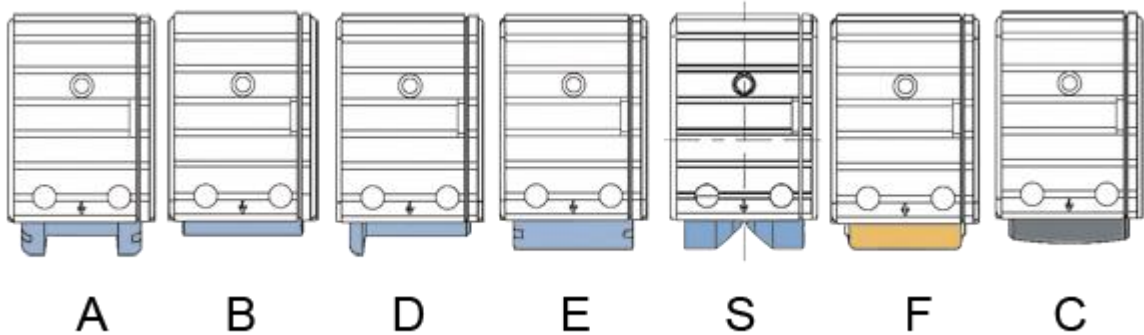

- A: Guided on both sides by flanges for rail systems
- B: Wheels without any flanges, optionally fitted with lateral guide rollers, also with concave shape or contour to customer specifications
- D: Wheels guided by a flange on one side for units running at floor level
- E: Larger diameter wheels without a flange for increased ground clearance
- S: Wheels of prismatic, trapezoidal or concave shape for guided applications
- F: Flangeless wheels with a Hydropur tyre for high acceleration & quiet running characteristics
- C: Flangeless, concave polyamide wheels for quiet operation

#### Many connection variants

- Prepared mounting surfaces for virtually any connection: from top and end connection arrangements with bolted and welded connection elements, to side and pin connection arrangements

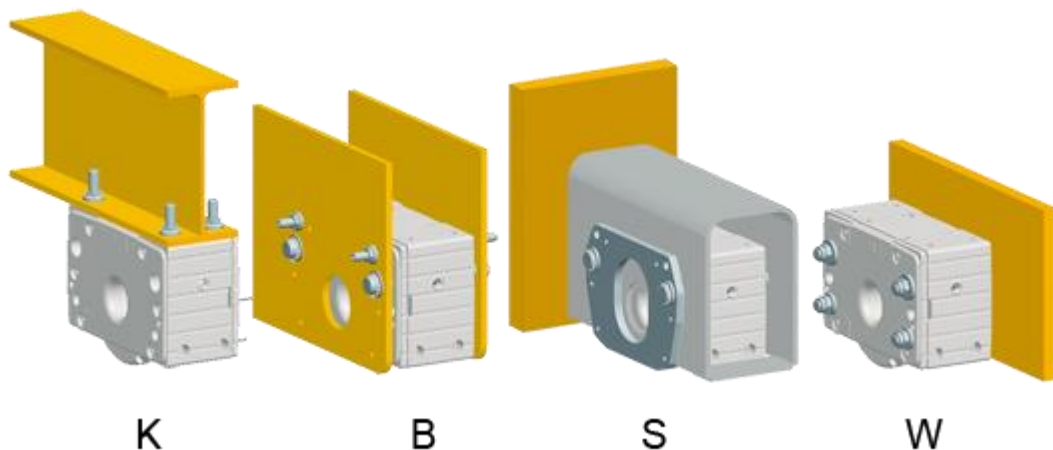

- K: Top connection
- B: Pin connection
- S: End connection
- W: Side connection

## Tailored solutions

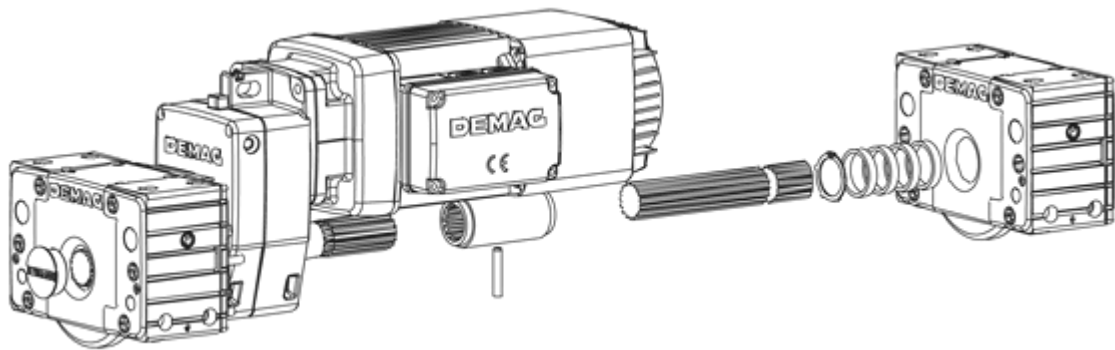

- Complete travel units with precisely matching geared motors from the Demag modular drive system
- High rigidity thanks to special stiffeners
- High ground clearance for wheel blocks due to compact system design. Complete drive units with gearbox engineered to match the wheel load
- Horizontal guide roller arrangements and buffers in various sizes and designs (optional)

## Simple assembly

- Housings ready for direct connection to superstructures
- Simple connection to superstructures thanks to tight design, effective housing position tolerances and precise geometry in all planes
- Laser alignment system for simple and precise wheel block alignment
- Simple wheel replacement without the need for re-alignment of top connection thanks to patented asymmetrical housing
- Wheel blocks can also be moved and aligned laterally after they have been installed in hollow sections and beams (for top, end and pin connection arrangements)

## Minimal maintenance

- Cast housing enclosed on five sides reliably protect the travel wheels against mechanical influence
- Generously dimensioned grooved ball bearings which are lubricated for life, tapered roller bearings from size DRS 250
- Travel wheels made of self-lubricating spheroidal-graphite cast iron (GGG 70) for low friction and high resistance to wear
- Integrated wear indicator on wheels with flanges for remote visual diagnosis